

# Pipestone County

## Rural School Locator Map

(Using 2018 Plat Map of Pipestone County)

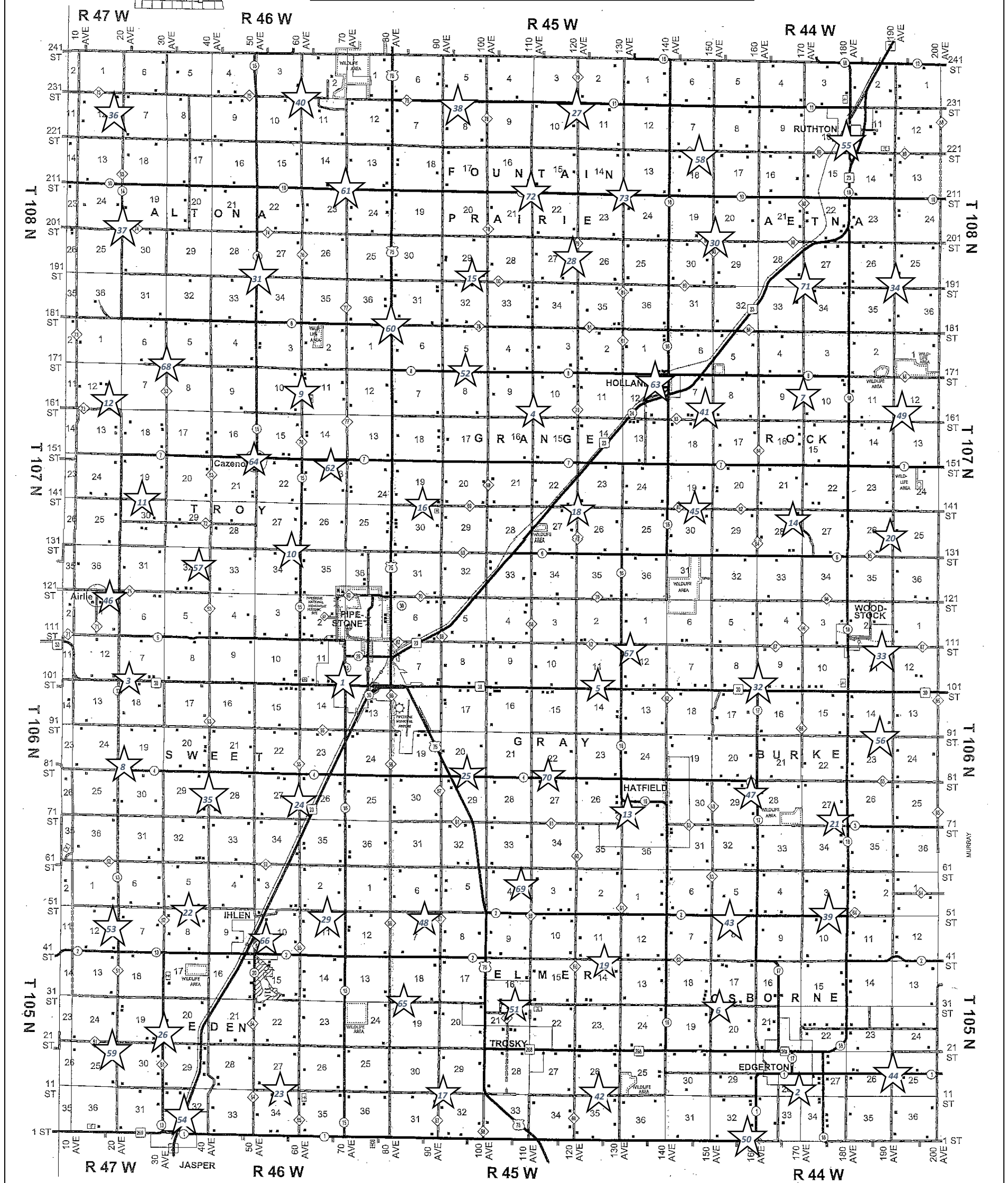

### The Country School Project

The Pipestone County Historical Society marked 2012 as the “*The Year of the Country School*”, 50 year after the last country school in Pipestone County was consolidated and closed. Volunteers gathered stories and photo from former country school student and teachers. This information was consolidated into a publication “*Rural Schools of Pipestone County*”. At the same time information on the location of the 73 country schools was gathered and a fund-raising campaign held to place markers at the sites where those schools once stood. Efforts were successful! In the summer of 2013 the 18” by 24” metal signs were made and placed at the sites of 69 of the schools; those considered to be truly “rural” and not within one of the small communities dotting the map of Pipestone County. As you use this map to explore the rural school history of the county look for signs like the one on the left!